

**MANUFACTURED BY:**

Cy-Tech GmbH  
Happurger Str. 86  
90482 Nuremberg | Germany  
[info@indoorcycling.com](mailto:info@indoorcycling.com)  
[www.indoorcycling.com](http://www.indoorcycling.com)  
Phone: +49(0)911 / 54 44 50

# IC2

**MODEL NO: IC-IC2B1-01**

## CAUTION!

READ ALL PRECAUTIONS AND INSTRUCTIONS IN THIS MANUAL BEFORE YOU START USING THIS EQUIPMENT. PLEASE KEEP THIS MANUAL FOR FUTURE REFERENCE. IMPROPER ASSEMBLY, USE OR MAINTENANCE CAN VOID THE WARRANTY TERMS.

# ATTENTION



Warning labels on the IC2 indoor cycle must be replaced by warning labels in your language during the assembly process.

A

**⚠ WARNING**

1. Misuse of this machine may result in serious injury.
2. Read user manual prior to use and follow all warnings and instructions.
3. Replace label if damaged, illegible or removed.
4. Keep children away.
5. Use only a solid, level surface.
6. Maximum user weight is 130kg/287lbs.
7. Spinning pedals can cause injury.
8. This bike does not free-wheel.
9. Pedal speed should be reduced in a controlled manner.

**WARNING —**  
Use the stationary training equipment in a supervised environment.

# ATTENTION



EN

To download the owners manual in your language, visit the IC2 support section at: [www.teamicg.com](http://www.teamicg.com)



DE

Um das Handbuch in Ihrer Sprache herunterzuladen, besuchen Sie bitte den IC2 Support Bereich auf unserer Webseite unter [www.teamicg.com](http://www.teamicg.com)



FR

Pour télécharger le manuel d'utilisation dans votre langue, consultez la section Assistance IC2 sur: [www.teamicg.com](http://www.teamicg.com)



IT

Per scaricare il manuale nella vostra lingua, visitate la sezione del supporto per IC2 su: [www.teamicg.com](http://www.teamicg.com)



NL

Ga om de gebruiksaanwijzing in uw taal te downloaden naar het IC2 supportgedeelte onder: [www.teamicg.com](http://www.teamicg.com)



ES

Para descargarse el manual de usuario en su idioma, por favor acceda a la sección de soporte técnico de la bici IC2 en: [www.teamicg.com](http://www.teamicg.com)



PT

Para transferir o manual de utilizador no seu idioma, visite a secção „Suporte“ da IC2 em: [www.teamicg.com](http://www.teamicg.com)



DK

Besøg IC2 supportafsnittet [www.teamicg.com](http://www.teamicg.com) for at downloade brugermanualen på dit sprog



FI

Lataa omistajan käsikirja omalla kielelläsi IC2-ohjeosiosta sivustolta: [www.teamicg.com](http://www.teamicg.com)



NO

Du kan laste ned bruksanvisningen på ditt eget språk ved å gå til IC2 støttesiden på: [www.teamicg.com](http://www.teamicg.com)



SE

Du kan hämta bruksanvisningen på ditt språk under IC2-support på [www.teamicg.com](http://www.teamicg.com)



PL

Aby pobrać podręcznik użytkownika w swoim języku, należy wejść na zakładkę IC2 support na stronie: [www.teamicg.com](http://www.teamicg.com)



TR

Kullanıcı kılavuzunu kendi dilinizde indirmek için [www.teamicg.com](http://www.teamicg.com) sayfasının IC2 deste bölümünü ziyaret edebilirsiniz



CN

在IC2的客户服务网站，您可以下载各种语言的用户手册 [www.teamicg.com](http://www.teamicg.com)



JP

オーナーズマニュアルの各言語版は、以下サイトのIC2サポートページからダウンロードいただけます。 [www.teamicg.com](http://www.teamicg.com)



KR

IC2 지원 센터([www.teamicg.com](http://www.teamicg.com))에서 해당 언어 버전의 사용설명서를 다운로드할 수 있습니다..

# TABLE OF CONTENTS

**IMPORTANT PRECAUTIONS P.5-6**

**GETTING STARTED P.7**

**HOW TO ASSEMBLE THE INDOOR CYCLE P.8-10**

**INITIAL INSTALLATION CHECKS P.11-12**

**HOW TO ADJUST THE INDOOR CYCLE P.13-15**

**HOW TO OPERATE THE INDOOR CYCLE P.16**

**HOW TO MOVE THE INDOOR CYCLE P.16**

**PREVENTIVE MAINTENANCE P.17-21**

**MAINTENANCE ACTIVITY PLAN P.22**

**LIMITED WARRANTY P.23-24**

**SPARE PARTS P.25-26**

**CORPORATE OFFICES P.27**

## **TECHNICAL SPECIFICATIONS:**

The ICG IC2 Bike is according to EN ISO 20957-1 and EN ISO 20957-10, a Class S product for use in a controlled environment such as sports or fitness facilities under the supervision of a trainer.

<b>FOOT PRINT:</b>	<b>53 X 115 CM / 20.9 X 45.3 INCH</b>
<b>WEIGHT OF BIKE:</b>	<b>48 KG / 106 LBS</b>
<b>MAX SADDLE HEIGHT:</b>	<b>116 CM / 45,7 INCH</b>
<b>MAX HANDLEBAR HEIGHT:</b>	<b>119 CM / 47 INCH</b>
<b>MAX USER WEIGHT:</b>	<b>130 KG / 287 LBS</b>

# IMPORTANT PRECAUTIONS

## WARNING!

To reduce the risk of serious injury due to improper use of the training equipment, carefully read and adhere to the following important precautions and information before operating the bike.

- 1.** It is the responsibility of the owner to ensure that all users are informed of all warnings and precautions for proper use of the training equipment and it is only authorized for use in a supervised environment with qualified instructors.
- 2.** Do not operate the training equipment until it has been properly assembled and inspected as described in this manual.
- 3.** Keep the training equipment away from moisture and dust. Do not place the training equipment in a garage, covered patio, near water or pools. Operating temperature of the training equipment has to be between 15°C~ 40°C Celsius (59°~104°F) at max. humidity of 65%.
- 4.** Always place the training equipment on a stable, level surface. If the training equipment is to be placed on a hardwood floor or carpet, it is recommended to place a floor mat beneath the bike, to protect the floor from becoming damaged.
- 5.** The level of safety of the training equipment can only be guaranteed if it is regularly checked for possible damage as well as wear and tear (e.g. fixing points, pedals, toe straps, etc.). Consult an authorized service provider or the manufacturer to ensure the regular inspections are properly carried out.
- 6.** Carry out all maintenance, care and service procedures as described in this manual on a regular basis. Defective parts must be replaced immediately, and the device must not be used until the repairs have been carried out. Only use original parts from the manufacturer. Repairs must only be carried out by from manufacturer authorized service technicians.
- 7.** Unsupervised children should be kept away from the training device at all times.

# IMPORTANT PRECAUTIONS

**8. WARNING:** The training equipment can be used by children aged from 14 years and above and persons with lack of experience and knowledge if they have been given supervision or instruction concerning use of the appliance in a safe way and understand the hazards involved. Persons with reduced physical, sensory or mental capabilities are prohibited from using the training equipment. Children shall not play with the training equipment. Cleaning and user maintenance shall not be made by children without supervision.

**9.** The training equipment must not be used by persons exceeding weight of 287 lbs/130 kg.

**10.** Always wear appropriate tight-fitting cycling or athletic attire and sturdy shoes, preferably cycling shoes, while operating the bike. Unfastened shoelaces may become caught in the drive system and lead to injury.

**11.** If you feel pain or dizziness while exercising, stop immediately. It is recommended that you consult a doctor if the pain does not subside for an extended period of time.

**12.** Only exercise within your physical limitations.

**13.** This stationary training equipment is not suitable for high accuracy purposes.

## **WARNING!**

If you have pre-existing health problems or a disability, it is recommended that you consult your physician, in order to find the training method which is best suited to you. Incorrect or extensive training can result in serious health injuries.

The manufacturer expressly assumes no responsibility for health risks, personal injury, property damage or consequential damages sustained by or through the use of this device, unless it is a case of consequential damage which can be traced back to faulty material and/or manufacturing, and which come under the responsibility of the manufacturer.

# GETTING STARTED

## DEAR CUSTOMER,

Congratulations for selecting the ICG IC2. The ICG indoor cycle offers an impressive array of features designed to enhance cardiovascular fitness, tone muscles, and develop endurance. Whether users are beginners or experienced athletes, the ICG IC2 offers workouts that will help users to reach their individual fitness goals.

**IMPORTANT:** Read this manual carefully before assembling or using the indoor cycle. If you have questions after reading this manual, please contact your local distributor or refer to the website [www.indoorcycling.com](http://www.indoorcycling.com). Before reading further, please familiarize yourself with the parts that are labeled in the drawing below.

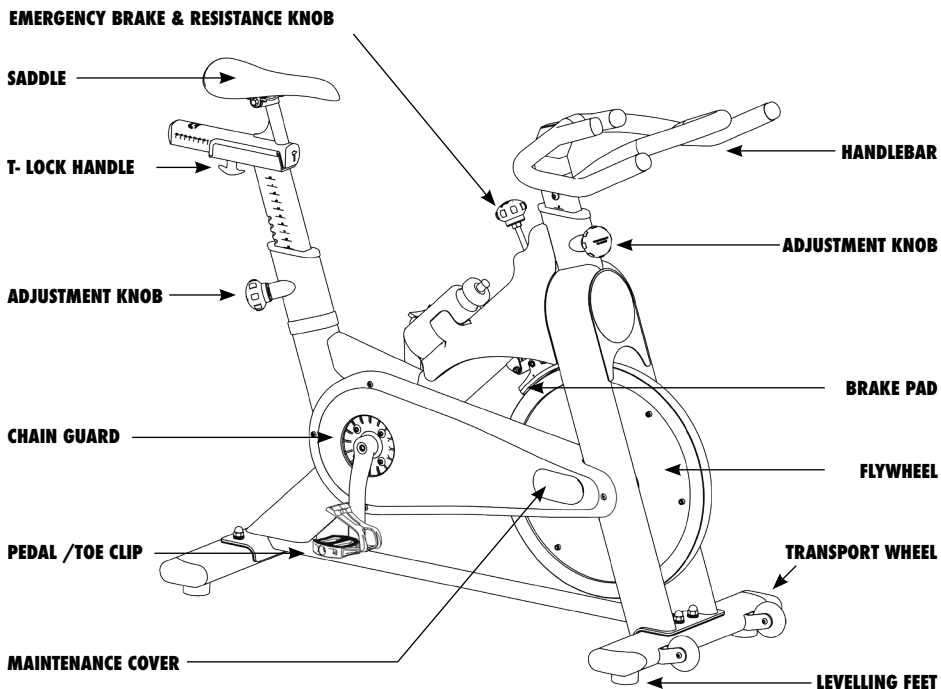

**YOU WILL FIND THE PRODUCTION CODE ON THE LEFT SIDE OF THE ICG IC2 WITHIN THE LOWER RANGE OF THE FRAME. PLEASE REGISTER THESE IN SERVICING AND MAINTENANCE LISTS.**

# HOW TO ASSEMBLE THE INDOOR CYCLE

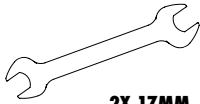

2X 17MM  
1X 13MM

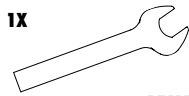

1X  
15MM  
PEDAL WRENCH



5MM



2  
PEOPLE

**1.**

**ASSURE THAT PLASTIC GASKET IS PLACED BETWEEN STABILIZER AND FRAME.**

**2.**

7NM

**ASSURE THAT BLACK RUBBER WASHER IS PLACED BETWEEN UPPER FRAME AND BOLT/WASHER.**

**3.**

**ASSURE THAT PLASTIC GASKET IS PLACED BETWEEN STABILIZER AND FRAME. GASKET SHOULD NOT BE VISIBLE ONCE ASSEMBLED.**

**4.**

**ASSURE THAT BLACK RUBBER WASHER IS PLACED BETWEEN UPPER FRAME AND BOLT/WASHER.**



# HOW TO ASSEMBLE THE INDOOR CYCLE



2X 17MM  
1X 13MM

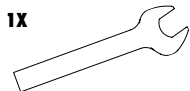

1X  
15MM  
PEDAL WRENCH

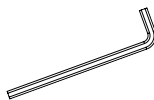

5MM



2  
PEOPLE

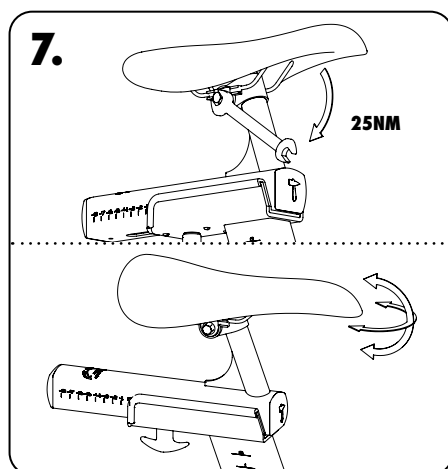
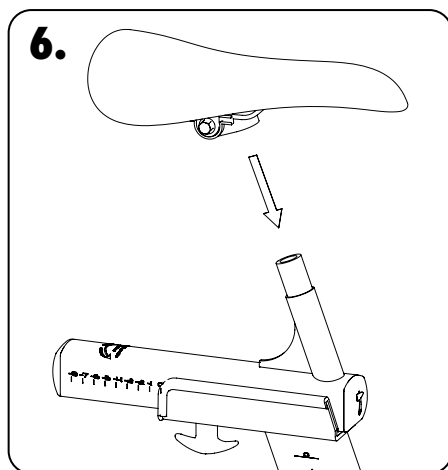
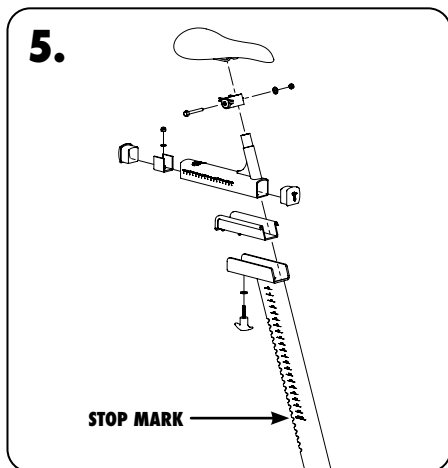

## WARNING!

Make sure the seat is fixed properly in a **LEVEL HORIZONTAL** position and securely tightened from both sides!

# HOW TO ASSEMBLE THE INDOOR CYCLE

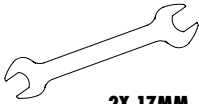

2X 17MM  
1X 13MM

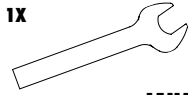

1X  
15MM  
PEDAL WRENCH



5MM



2  
PEOPLE

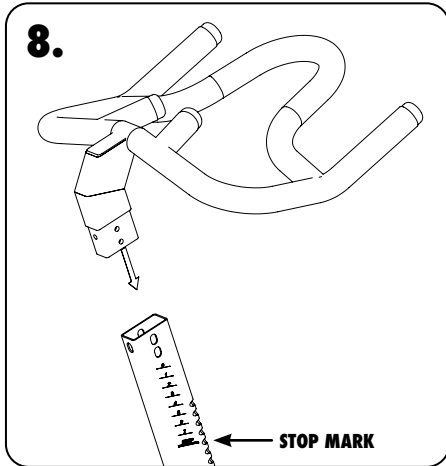

8.

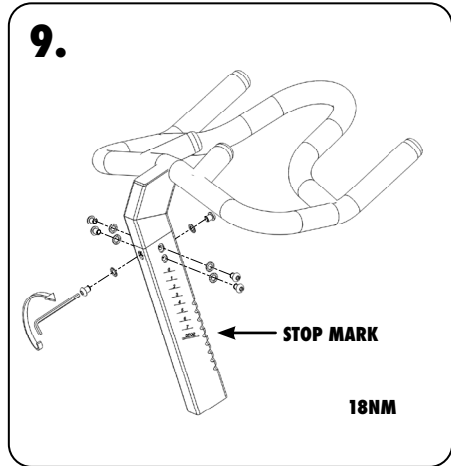

9.

## WARNING!

Pedal marked **R** installed on right crank (clockwise). Pedal marked **L** installed on left crank (counter-clockwise) Pedals must be fastened with significant strength to avoid loosening with use of the ICG IC2.

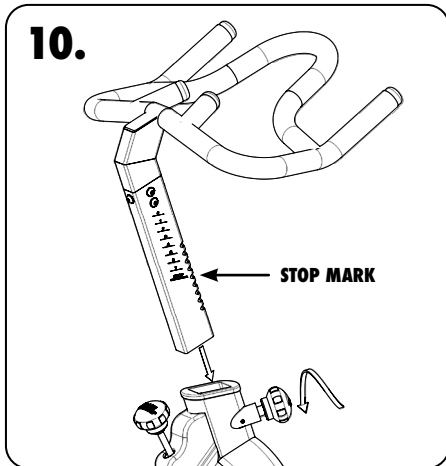

10.

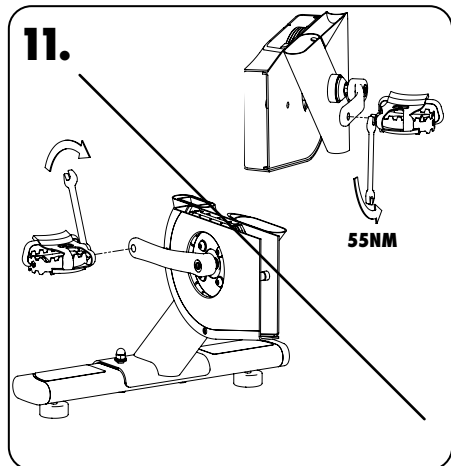

11.

# INITIAL INSTALLATION CHECKS

The cycle tune-up must be performed at initial installation of the ICG IC2 for optimal performance and longevity. Please read and follow all instructions below. If the ICG IC2 is not installed and tuned as described, components may wear excessively and the ICG IC2 may become damaged. If you have questions about the installation, please contact [service@indoorcycling.com](mailto:service@indoorcycling.com).

**Note: Some maintenance procedures require acid-, silicone- and solvent free spray lubricant** (for example BRUNOX), and white lithium grease.

- 1.** Make sure that the ICG IC2 is leveled. If the ICG IC2 rocks on the floor, turn the leveling feet underneath the front and/or rear stabilizer until the rocking motion is eliminated.
- 2.** Verify emergency brake function to assure that emergency brake functions correctly.
- 3.** Brake pad calibration: Turn resistance knob counterclockwise as far as possible (minimum braking effect), verify that there is a slight separation of the brake pad from flywheel. Brake pad should barely touch the flywheel when resistance knob is turned counter-clockwise as far as it can go.
- 4.** Apply spray lubricant to the brake pad using the lubrication holes on the plastic part or the brake pad and externally on the felt pad. Make sure brake pad is thoroughly soaked from end to end with lubricant spray. Then, wipe the excess off from the flywheel.  
**\* Best Practice: Use a refillable spray bottle filled with non-aerosol acid-, silicone- and solvent free spray lubricant purchased by the gallon (3.7 L) at the local hardware store.**
- 5.** Apply lithium grease to the threads on the lower end of the brake rod. First, turn the resistance knob clockwise until it stops. Apply a small amount of white lithium grease to the threads on the brake rod above the two lock nuts. Then, turn the resistance knob counter-clockwise until it stops.

# INITIAL INSTALLATION CHECKS

6. Apply lithium grease on the metal threads of all the adjustment knobs.
7. Verify four (4) allen nuts on RS pulley for tightness. If loose, apply Loctite Threadlocker Blue-243 and retighten.
8. Verify R and L crank arm allen bolts for tightness. If loose, apply Loctite Threadlocker Blue-243 and retighten.
9. Verify belt tension. Check if belt drive is firmly tightened and does not slip while riding under resistance load. In case that the belt slips, proceed using the adjustment technique as described on page (18). Please note that a belt drive gear never shows slack. In case of adjustment do not apply too much tension.
10. Wipe down bike frame with rag moistened with solvent free spray lubricant
11. Some parts of the ICG IC2 may become loose during shipment. Check crank arms, check all exposed screws, bolts, and nuts, and make sure that they are properly tightened.

**Allow a minimum safety distance away from the nearest equipment, objects or walls as illustrated below.**

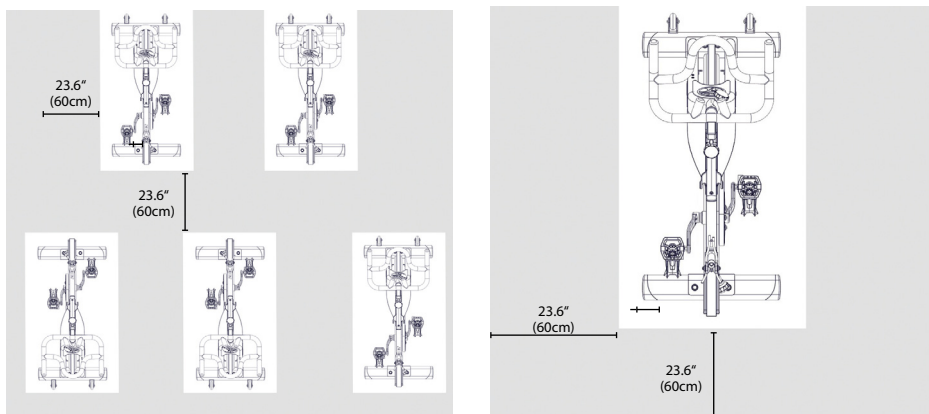

## CUSTOMER SERVICE

1. Provide basic maintenance instructions to client and direct them to detailed maintenance instructions (page 14-19)
2. Sign-off sheet provided to client to confirm explanation of maintenance procedures/manual and verification of condition of bikes?

# HOW TO ADJUST THE INDOOR CYCLE

The ICG IC2 can be adjusted for maximum comfort and exercise effectiveness. The instructions below describe one approach to adjusting the ICG IC2 to ensure optimal user comfort and ideal body positioning; you may choose to adjust the ICG IC2 cycle differently.

## PEDAL STRAP ADJUSTMENT:

Sit on the saddle and position your feet on the pedals, with the balls of your feet directly above the spindles of the pedals (see the drawing below). Adjust the pedal straps so the toe clips (cages) are snug but not too tight. Note: In the case of a bike being fitted with combi-pedals, the pedals feature toe clips on one surface and SPD cleats on the opposite surface. If desired, use the shoe cleats with cycling shoes instead of the toe clips.

Do not adjust saddle height beyond the STOP mark on the stem and ensure the pop pin is fully engaged and securely tightened

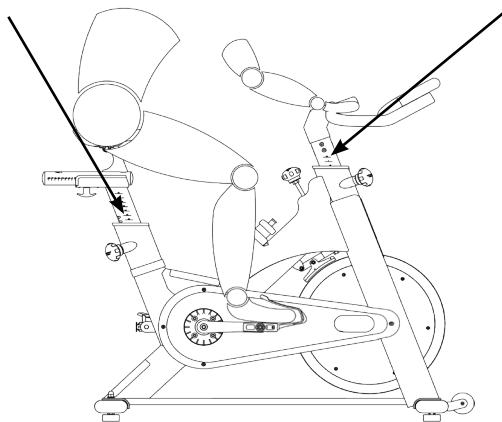

Do not adjust handlebar height beyond the STOP mark on the stem and ensure the pop pin is fully engaged and securely tightened

## WARNING!

Please avoid overtightening the pop pin adjustment knob as this may cause damages to the vertical aluminum stems.

## SADDLE HEIGHT ADJUSTMENT:

Sit on the saddle and slowly pedal until the right pedal is in the lowest position. Your knees should be slightly bent without a dropping of the hips. To avoid hyper extending your knees, make sure that your legs are not completely straight.

# HOW TO ADJUST THE INDOOR CYCLE

## SADDLE HORIZONTAL ADJUSTMENT:

Proper horizontal adjustment of the saddle is very important in avoiding injury to the knees. Sit on the saddle and move the pedals until the crank arms are in horizontal position.

Using your forward most leg as a marker, your kneecap should be directly above the center of the pedal so that a straight line is created between knee and center of the pedal (see the dotted line in image below). To adjust the horizontal position of the saddle, first dismount the ICG IC2. Next, loosen the rear adjustment knob, slide the saddle forward or backward as required, and then retighten the knob.

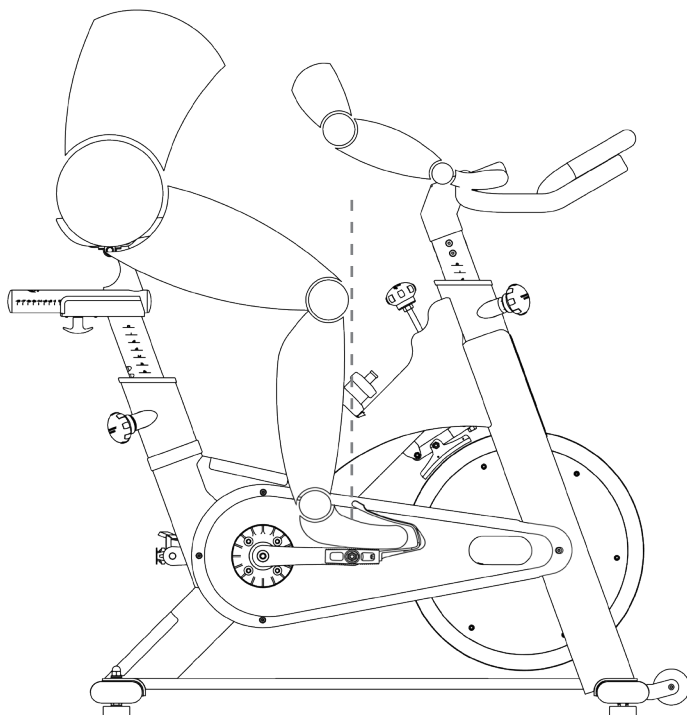

# HOW TO ADJUST THE INDOOR CYCLE

## HANDLEBAR ADJUSTMENT:

Begin with the top of the handlebar at relatively the same height or just slightly higher than the top of the saddle (**dotted horizontal line A in the drawing above**) and at a neutral fore/aft position (**see dotted vertical line B in drawing above**). If your knees touch the handlebars or if you experience back discomfort while pedalling for extended periods of time, the height of the handlebars can be adjusted. First, dismount the ICG IC2. Next, turn the front adjustment knob counter clockwise, slide the handlebar post up or down, and then re-tighten the adjustment knob.

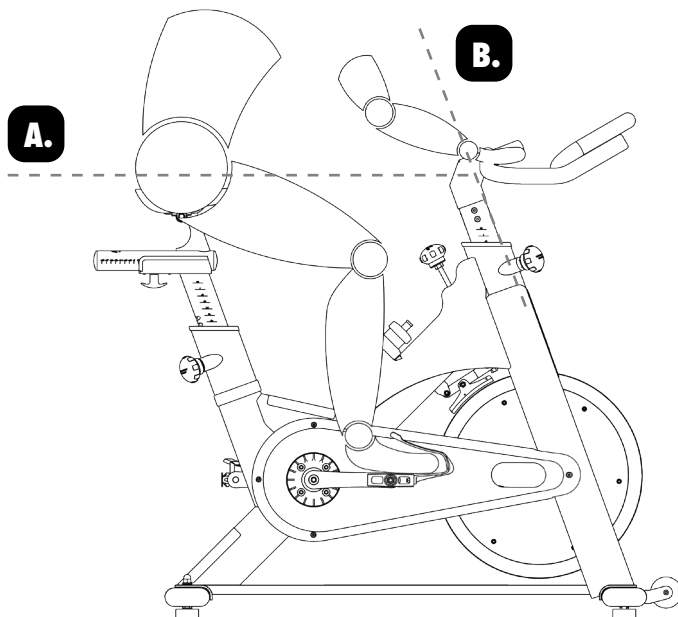

If your ICG IC2 is equipped with a regular 2 way handlebar. If the handlebar is too close to the saddle, your breathing may feel restricted; if the handlebar is too far from the saddle, you may experience back discomfort. To adjust the horizontal position to the handlebar, first dismount the ICG IC2.

Check for proper handlebar position by positioning your elbow so that it is touching the front tip of the saddle at a 90 degree angle and checking that the fingertip of your middle finger is touching the handlebar at the mid-point. If it is not as described then loosen the fore-aft T-lock handle and slide the saddle slightly forward or backward until your middle finger is touching the handlebar at the mid-point, and then retighten the handle. Changing your hand position can change the angle of your back, neck, and arms. To minimize the stress on your muscles during your workouts, change your hand position frequently.

# HOW TO OPERATE THE INDOOR CYCLE

## RESISTANCE ADJUSTMENT:

The preferred level of difficulty in pedalling (resistance) can be regulated in fine increments by use of the resistance knob. To increase the resistance, turn the resistance knob clockwise. To decrease the resistance, turn the knob counter clockwise.

**IMPORTANT:** To stop the flywheel (wheel) while pedalling, push down on the red brake knob. The flywheel should quickly come to a complete stop. Please make sure your shoes are fixed into the toe clip or in case cycling shoes are used your shoe cleat is connected to the pedal binding while riding.

**WARNING:** Risk of injury. The ICG IC2 does not have a free moving flywheel (wheel); the pedals will continue to move together with the flywheel until the flywheel stops. Reducing speed in a controlled manner is required. To stop the flywheel immediately, push down the red break knob. Always pedal in a controlled manner and adjust your desired cadence according to your own abilities.

**PUSH THE RED KNOB DOWN = EMERGENCY STOP**

**RED RESISTANCE KNOB (TURN)**

**EMERGENCY BRAKE (PUSH)**

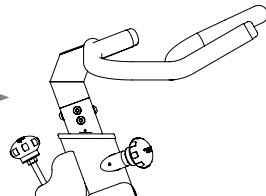

## HOW TO MOVE THE ICG IC2:

Due to the weight of the ICG IC2, it is recommended that two persons move it. While one person lifts the back of the ICG IC2, the second person firmly holds the handlebar and tips the ICG IC2 forward until it rolls on the wheels. Carefully move the indoor cycle to the desired location and then lower it. **CAUTION: To reduce the risk of injury, use extreme caution while moving the indoor cycle. Do not attempt to move it over uneven surfaces and make sure a safety space of min 20 inch to the nearest equipment is redeemed.**

If the ICG IC2 rocks on the floor after being set down, turn the levelling feet (see diagram) underneath the front or rear stabilizer until the rocking motion is eliminated.

**Important:** Please do not unscrew the levelling feet more than ½ inch!

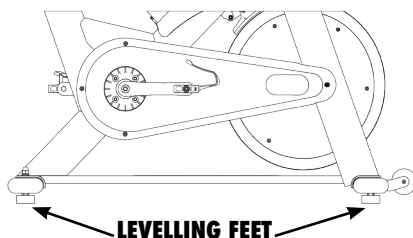



# PREVENTIVE MAINTENANCE

## WARNING!

### REGULAR MAINTENANCE MUST BE PERFORMED ON THE ICG IC2 FOR OPTIMAL PERFORMANCE AND LONGEVITY.

Please read and follow all instructions below. If the ICG IC2 is not maintained as described, components may wear excessively and the ICG IC2 may become damaged. Improper maintenance will void the warranty terms. If you have questions about maintenance, contact your local distributor or refer to [www.indoorcycling.com](http://www.indoorcycling.com)

**NOTE: MANY MAINTENANCE PROCEDURES REQUIRE LUBRICANT SPRAY. MANUFACTURER RECOMMENDS FOR EXAMPLE BRUNOX OR A SIMILAR SOLVENT- AND ACID FREE LUBRICANT.**

### DAILY MAINTENANCE:

1. Make sure that the ICG IC2 is leveled. If the ICG IC2 rocks on your floor, turn the levelling feet underneath the front or rear stabilizer until the rocking motion is eliminated (see HOW TO MOVE THE ICG IC2 on page 13).
2. After each user finishes exercising, the ICG IC2 should be disinfected and cleaned to maintain a hygienic environment. First, apply a disinfectant spray to the handlebars and the saddle. Using a lint-free cloth, dry the handlebars and the saddle. Next, apply a small amount of disinfectant to a lint-free cloth and clean the adjustment knobs and the adjustment handles. Avoid using strong detergents on the ICG IC2 frame.

### WEEKLY MAINTENANCE:

1. Apply a small amount of the lubrication spray to a lint-free cloth, and thoroughly clean the frame, the handlebar slider and seat sliders the flywheel and the plastic parts of the ICG IC2.
2. For optimal performance of the resistance system, and to minimize wear on the brake pad, the acid-, silicone- and solvent free spray lubricant should be applied to the brake pad using the lubrication holes on the plastic part of the brake pad. If fuzz or lint appears on the brake pad, the brake pad has become too dry-lubricant spray should be applied more frequently. Make sure brake pad is thoroughly soaked from end to end with lubricant spray. Then, wipe the excess off.

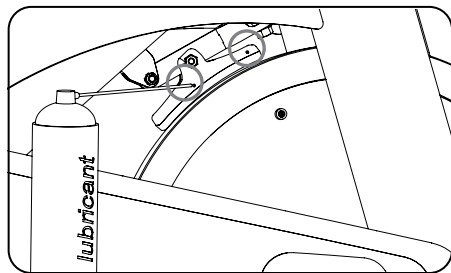

# PREVENTIVE MAINTENANCE

## BI-WEEKLY MAINTENANCE:

**1.** The ICG IC2 should not be used if the emergency brake system is not working properly. While sitting on the saddle and pedalling, test the brake by pushing down the brake knob. The flywheel should come to a quick and complete stop.

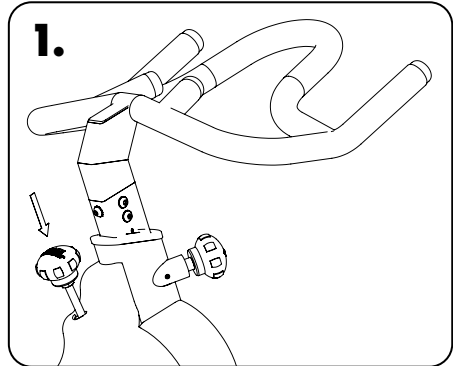

**2.** To maintain the easy adjustability of the saddle post, the saddle post should be cleaned and lubricated. Turn the rear adjustment knob counter clockwise and slide the saddle post out of the frame. Apply a small amount of lubricant spray to a lint-free cloth, and clean the saddle post (**A**). Next, apply a small amount of lubricant spray inside of the rear frame sleeve. Then, reinsert the saddle post into the frame and adjust it to the desired height.

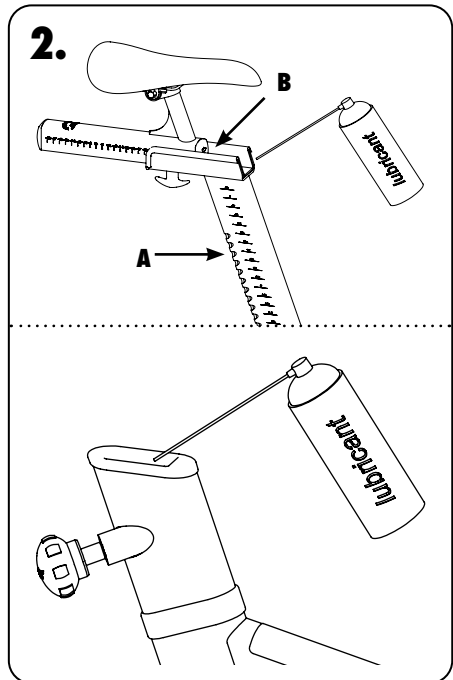

Next, loosen the rear lock handle and slide the saddle carriage as far backward as possible. Apply a small amount of lubricant spray to a lint-free cloth, and clean the top of the saddle slide (**B**). Then, slide the saddle carriage as far forward as possible and clean the top of the saddle slide. Finally, adjust the saddle to the desired position.

# PREVENTIVE MAINTENANCE

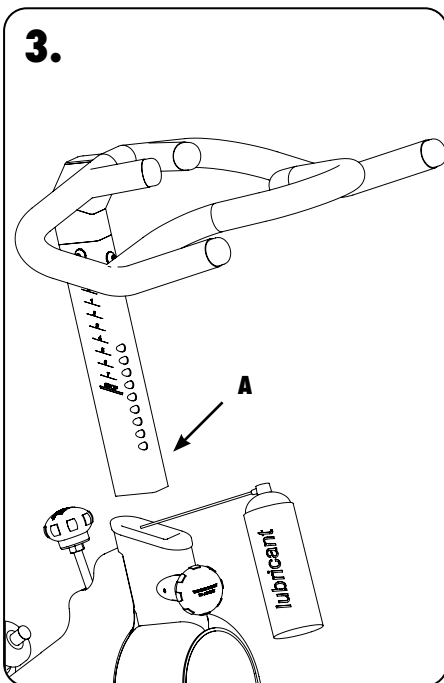

**3.** To maintain the easy adjustability of the handlebar post, the handlebar post should be cleaned and lubricated. First, turn the front adjustment knob counter clockwise and slide the handlebar post out of the frame. Apply a small amount of lubricant spray to a lint-free cloth, and clean the handlebar post (**A**). Next, apply a small amount of lubricant spray inside of the front frame sleeve.

Then, reinsert the handlebar post into the frame and adjust it to the desired height.

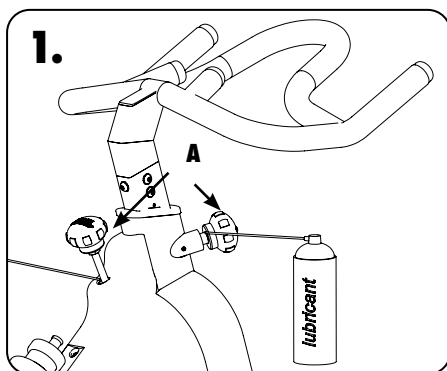

## MONTHLY MAINTENANCE:

**1.** To maintain the smooth function of the adjustment knobs controlling the handlebar and saddle, the metal threads on the adjustment knobs (**A**) must be lubricated.

# PREVENTIVE MAINTENANCE

**2.** To maintain the easy adjustability of the resistance system, the screw threads on the lower end of the brake rod should be lubricated. First, turn the resistance knob clockwise until it stops. Next, look under the right or left side of the frame and locate the brake rod (**C**). Apply a small amount of synthetic grease (white lithium grease) to the thread on the brake rod. Then, turn the resistance knob counter-clockwise until it stops.

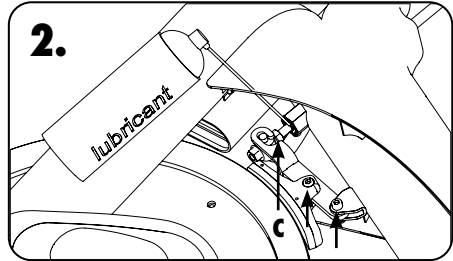

**3.** Some parts of the ICG IC2 may become loose as a result of repeated use. Check pedals, toe clips, and pedal straps, and make sure that they are properly tightened. Next, check all exposed screws, bolts, and nuts, and make sure that they are properly tightened. Finally, check the saddle to make sure that it is not loose or damaged.

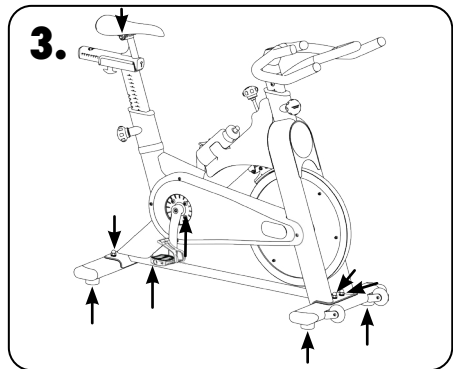

**4.** The brake pad will become worn as a result of repeated use. The ICG IC2 should not be used if the emergency braking system is not working properly (see page 13)! Should you feel that the resistance system's functions are deficient, it is essential to fine-tune the resistance system before the bike is used again! Please check the setting of the brake system as follows: First turn the resistance regulator on the brake system as far as it will go to the left (minimum braking effect). If the setting is correct, the brake pads should be flush with the flywheel and barely touching so that it's possible to cycle with a hardly noticeable amount of resistance. The brake pad can be adjusted using a 10 mm wrench. Next, check the brake pad for signs of wear. If the brake pad does show signs of excessive wear, thoroughly soak the brake pad with lubricant spray using the 2 lubrication holes (**B**), and then wipe the excess off.

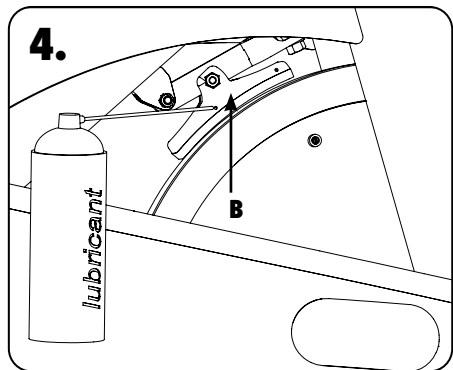

# PREVENTIVE MAINTENANCE

## 5. BELT DRIVE

**Important:** A loose belt as well as an overtightened belt may cause injury of the rider or damage to the drive system.

**Checking belt tension:** To check for a loose belt, sit on the saddle, place your feet on the pedals, move the pedals until the crank arms are horizontal. Next, pull up the emergency brake handle and hold it. Then, stand on the pedals and rock forward and backward. There should be no play or slip in the drive train. If there is slip or play in the drive train, this indicates that the belt is too loose.

**Correct a slipping belt drive train:** To adjust the belt, pull off the right and the left maintenance covers (A). Loosen the axle nut (B) on both ends of the flywheel axle by two full turns. Loosen the inner adjustment nut (D) facing the flywheel axle on each side of the flywheel. Next, loosen the lock nut (C).

Then, turn both (right and left sides) of the inner adjustment nuts (D) on the inside of the flywheel bracket  $\frac{1}{4}$  of a turn at a time (upward on the R side and downward on L side) until the belt is properly adjusted. Make sure to turn both adjustment nuts exactly the same amount to avoid misalignment of the flywheel. Re-check if the amount of play or slip in the drive train has disappeared.

Finally, retighten the two outer lock nuts (C) to secure the new adjustment and retighten the two axle nuts (B). At last reattach the maintenance covers (A).

Check if **belt drive** is firmly tighten and does not slip while riding under resistance load. In case that the belt slips, proceed using the same technique as described above. Please note that a belt drive gear never shows slack. In case of adjustment do not apply too much tension.

The manufacturer recommends using an ultrasonic voltage meter adhering to a natural frequency of the belt of  $103 \text{ Hz} \pm 3 \text{ Hz}$ . Ball bearing damage due to incorrect belt tension is excluded from warranty.

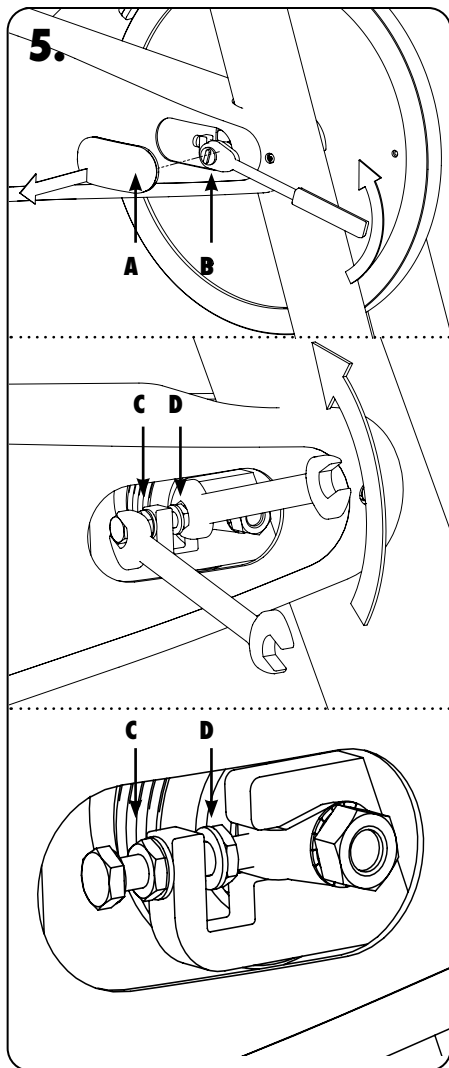

**GRAPHICS ARE THE RIGHT SIDE OF THE BIKE (RIDING POSITION)**

# MAINTENANCE ACTIVITY REQUIRED SCHEDULE

ACTIVITY	ROTATION	DETAILS
<b>FEET LEVELLING, DISINFECTION &amp; CLEANING OF THE BIKE</b>	<b>DAILY</b>	<b>P 16</b>
<b>SERVICING BRAKE PADS, DETAILED CLEANING OF THE ENTIRE BIKE</b>	<b>WEEKLY</b>	<b>P 17</b>
<b>CHECK EMERGENCY BRAKE FUNCTION</b>	<b>BI-WEEKLY</b>	<b>P 18</b>
<b>CLEAN AND LUBRICATE SADDLE &amp; HANDLEBAR SLIDERS / POSTS</b>	<b>BI-WEEKLY</b>	<b>P 18-19</b>
<b>CHECK ADJUSTMENT KNOBS</b>	<b>MONTHLY</b>	<b>P 19</b>
<b>CHECK BRAKE PAD FOR SIGNS OF WEAR</b>	<b>MONTHLY</b>	<b>P 20</b>
<b>CHECK BRAKE SYSTEM, LUBRICATE</b>	<b>MONTHLY</b>	<b>P 20</b>
<b>CHECK PEDALS, TOE CLIP &amp; STRAPS FOR SIGNS OF WEAR</b>	<b>MONTHLY</b>	<b>P20</b>
<b>CHECK ALL CONNECTIONS AND FIXINGS</b>	<b>MONTHLY</b>	<b>P20</b>
<b>CHECK BELT DRIVE TRAIN</b>	<b>MOTHLY</b>	<b>P21</b>

## EXAMPLES OF MAINTENANCE PLAN CHARTS FOR IN HOUSE SERVICE TECHNICIANS:

WEEKLY MAINTENANCE CHECKLIST					
BIKE NO.	PRODUCTION CODE	OBSERVATIONS	ACTION TAKEN	RESULT	NAME/DATE

# WARRANTY

Cy-Tech GmbH warrants that all new equipment will be free of manufacturing defects in workmanship and materials, becoming effective on the date of original installation. Parts repaired or replaced under the terms of this warranty will be warranted for the remainder of the original warranty period only. Warranty may vary by region or country. Please contact [www.indoorcycling.com](http://www.indoorcycling.com).

**Defects caused by inappropriate use or handling of the product may cause denegation of the manufacturers warranty.**

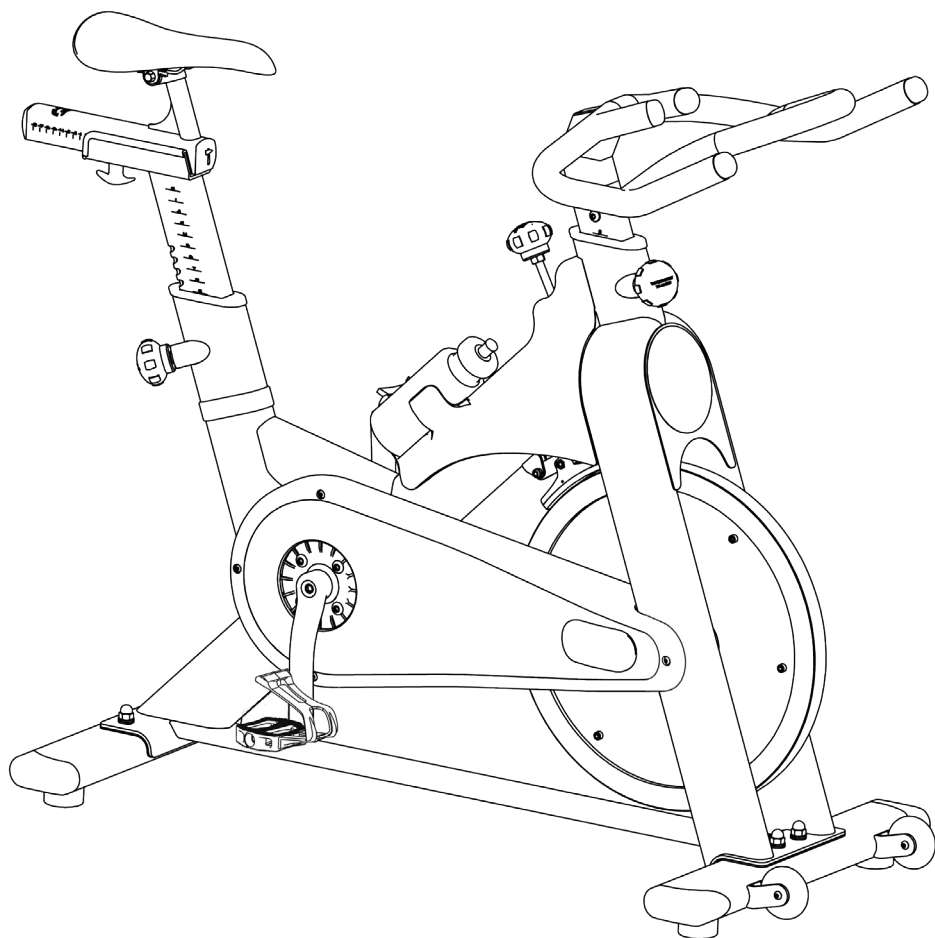

# WARRANTY

<b>5 YEARS WARRANTY:</b>	<b>FRAME CONSTRUCTION AND WELDING</b>
<b>3 YEARS WARRANTY</b>	<b>HANDLEBAR AND SADDLE ASSEMBLY, BRAKE SYSTEM (EXCLUDING BRAKE PAD), LEVER HANDLES AND KNOBS, CRANKS, BELT DRIVE SYSTEM, BOTTOM BRACKET ASSEMBLY, FLYWHEEL AND HUB ASSEMBLY, POWDER COATING OF FRAME PARTS.</b>
<b>2 YEARS WARRANTY :</b>	<b>PEDALS, INSERT SLEEVES FOR HANDLE BAR AND SADDLE POST, LEVELING FEET.</b>
<b>1 YEARS WARRANTY:</b>	<b>SADDLE CONSTRUCTION</b>

**THE FOLLOWING WEAR ITEMS ARE EXCLUDED FROM WARRANTY:**

Pedal straps, pedal binding system, water bottle holder.



# SPARE PARTS

Due to revisions, spare part order no. and specifications may be subject to change.  
For further information please contact your local distributor or visit [www.indoorcycling.com](http://www.indoorcycling.com).

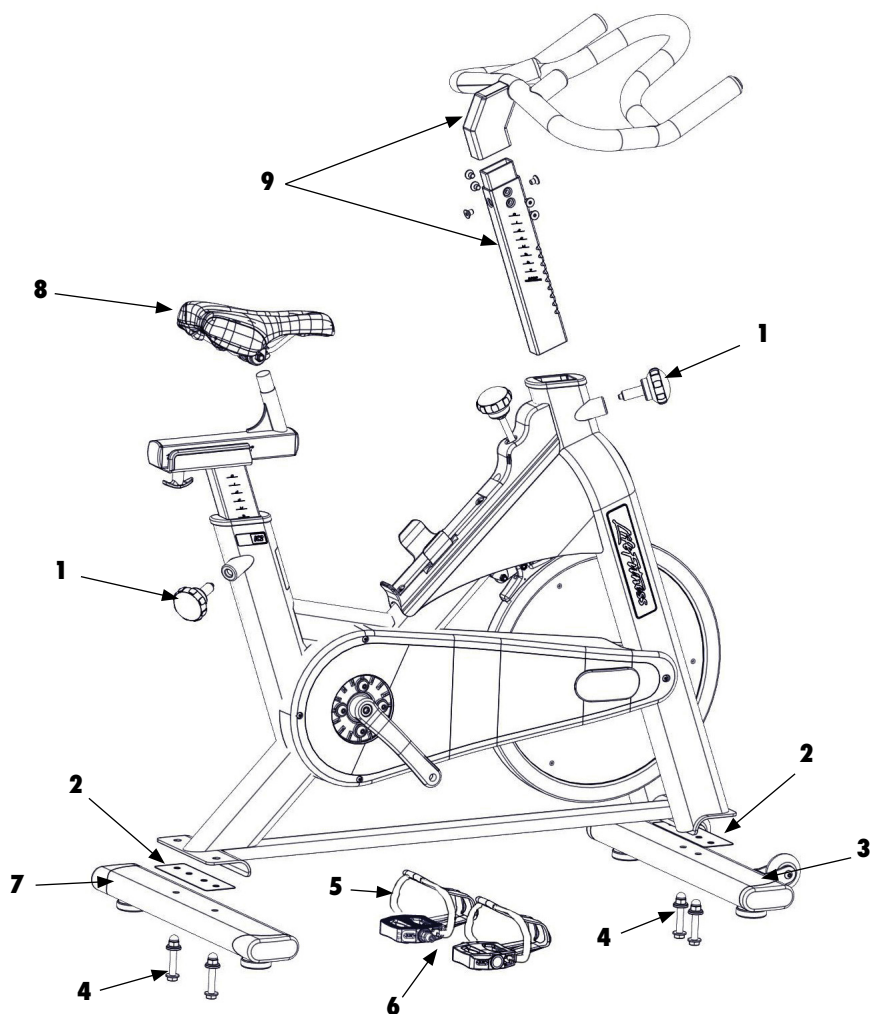

# SPARE PARTS

	DESCRIPTION	ITEM NUMBER
1	POP PIN KNOB	180-01-00027-01
2	RUBBER GASKET	140-03-00024-01
3	FRONT STABILIZER	140-02-00021-01
4	STABILIZER MOUNTING BOLT INCLUDING WASHER AND NUT	140-01-00025-01
5	PEDAL STRAP SET	150-03-00048-01
6	PEDALS SET	150-01-00005-03
7	REAR STABILIZER	140-02-00020-01
9	SADDLE	120-01-00015-02
10	HANDLEBAR AND STEM	110-01-00016-01

## CORPORATE HEADQUARTERS

Columbia Centre III, 9525 West Bryn Mawr Avenue, Rosemont, Illinois 60018 • U.S.A.  
847.288.3300 • FAX: 847.288.3703 • Service phone number: 800.351.3737 (toll-free within U.S.A., Canada)  
Global Website: [www.lifefitness.com](http://www.lifefitness.com)

### AMERICAS

North America  
Life Fitness, Inc. Columbia Centre III  
9525 West Bryn Mawr Avenue, Rosemont, IL 60018 U.S.A.  
Telephone: (847) 288 3300  
Service Email: [customersupport@lifefitness.com](mailto:customersupport@lifefitness.com)  
Sales/Marketing Email: [commercialsales@lifefitness.com](mailto:commercialsales@lifefitness.com)

#### Brazil

Life Fitness Brasil  
Av. Reboucas, 2315 Pinheiros,  
Sao Paulo, SP 05401-300 BRAZIL  
SAC: 0800 773 8282 option 2  
Telephone: +55 (11) 3095 5200  
Service Email: [suportebr@lifefitness.com](mailto:suportebr@lifefitness.com)  
Sales/Marketing Email: [vendasbr@lifefitness.com](mailto:vendasbr@lifefitness.com)

#### Latin America and Caribbean\*

Life Fitness, Inc. Columbia Centre III  
9525 West Bryn Mawr Avenue Rosemont, IL 60018 U.S.A.  
Telephone: (847) 288 3300  
Service Email: [customersupport@lifefitness.com](mailto:customersupport@lifefitness.com)  
Sales/Marketing Email: [commercialsales@lifefitness.com](mailto:commercialsales@lifefitness.com)

### EUROPE, MIDDLE EAST, and AFRICA (EMEA)

Netherlands and Luxembourg  
Life Fitness Atlantic BV  
Bijdorplein 25-31, 2992 LB Barendrecht  
THE NETHERLANDS  
Telephone: (+31) 180 646 666  
Service Email: [service.benelux@lifefitness.com](mailto:service.benelux@lifefitness.com)  
Sales/Marketing Email: [marketing.benelux@lifefitness.com](mailto:marketing.benelux@lifefitness.com)

#### United Kingdom

Life Fitness UK LTD  
Queen Adelaide, Ely, Cambs, CB7 4UB  
Telephone: General Office (+44) 1353.666017  
Customer Support (+44) 1353.665507  
Service Email: [uk.support@lifefitness.com](mailto:uk.support@lifefitness.com)  
Sales/Marketing Email: [life@lifefitness.com](mailto:life@lifefitness.com)

#### Germany, Austria, and Switzerland

Life Fitness Europe GMBH  
Neuhofweg 9, 85716 Unterschleisheim  
GERMANY  
Telephone:  
+49 (0) 89 / 31775166 Germany  
+43 (0) 1 / 6157198 Austria  
+41 (0) 848 / 000901 Switzerland  
Service Email: [kundendienst@lifefitness.com](mailto:kundendienst@lifefitness.com)  
Sales/Marketing Email: [vertrieb@lifefitness.com](mailto:vertrieb@lifefitness.com)

#### Spain

Life Fitness IBERIA  
C/Frederic Mompou 5, 1o1a  
08960 Sant Just Desvern Barcelona  
Spain  
Telephone: (+34) 93.672.4660  
Service Email: [servicio.tecnico@lifefitness.com](mailto:servicio.tecnico@lifefitness.com)  
Sales/Marketing Email: [info.iberia@lifefitness.com](mailto:info.iberia@lifefitness.com)

#### Belgium

Life Fitness Benelux NV  
Parc Industriel de Petit-Rechain, 4800 Verviers  
Belgium  
Telephone: (+32) 87 300 942  
Service Email: [servicio.benelux@lifefitness.com](mailto:servicio.benelux@lifefitness.com)  
Sales/Marketing Email: [marketing.benelux@lifefitness.com](mailto:marketing.benelux@lifefitness.com)

#### All Other EMEA Countries and Distributor Business EMEA\*

Bijdorplein 25-31, 2992 LB Barendrecht  
THE NETHERLANDS  
Telephone: (+31) 180 646 644  
Service Email: [EMEAServiceSupport@lifefitness.com](mailto:EMEAServiceSupport@lifefitness.com)

### ASIA PACIFIC (AP)

Japan  
Life Fitness Japan, Ltd  
4-17-33 Minami Aoyama 1F/B1F, Minato-ku - Tokyo 107-0062  
Japan  
Telephone: (+81) 0120.114.482  
Fax: (+81) 03-5770-5059  
Service Email: [service.lfj@lifefitness.com](mailto:service.lfj@lifefitness.com)  
Sales/Marketing Email: [sales@lifefitnessjapan.com](mailto:sales@lifefitnessjapan.com)

#### Hong Kong

Life Fitness Asia Pacific LTD  
32/F, Global Trade Square  
21 Wong Chuk Hang Road  
Hong Kong  
Telephone: (+852) 2575.6262  
Service Email: [Service.HK@lifefitness.com](mailto:Service.HK@lifefitness.com)  
Sales/Marketing Email: [hongkong.sales@lifefitness.com](mailto:hongkong.sales@lifefitness.com)

#### All Other Asia Pacific countries and distributor business Asia Pacific\*

32/F, Global Trade Square  
21 Wong Chuk Hang Road  
Hong Kong  
Telephone: (+852) 2575.6262  
Fax: (+852) 2575.6894  
Service Email: [Service.AP@lifefitness.com](mailto:Service.AP@lifefitness.com)  
Sales/Marketing Email: [Marketing.HK.Asia@lifefitness.com](mailto:Marketing.HK.Asia@lifefitness.com)

\*Also check [www.lifefitness.com](http://www.lifefitness.com) for local representation or distributor/dealer

## **CAUTION.**

READ ALL PRECAUTIONS AND INSTRUCTIONS IN THIS MANUAL BEFORE YOU BEGIN USING THIS EQUIPMENT. PLEASE KEEP THIS MANUAL FOR FUTURE REFERENCE. IMPROPER ASSEMBLY, SET UP, USE OR MAINTENANCE MAY VOID THE WARRANTY.



**EMAIL:** [INFO@INDOORCYCLING.COM](mailto:INFO@INDOORCYCLING.COM)  
**WEBSITE:** [WWW.INDOORCYCLING.COM](http://WWW.INDOORCYCLING.COM)

© 2021 Cy-Tech GmbH

Manufactured by: Cy-Tech GmbH  
Happurger Str. 86 90482 Nuremberg Germany